

Grading 1

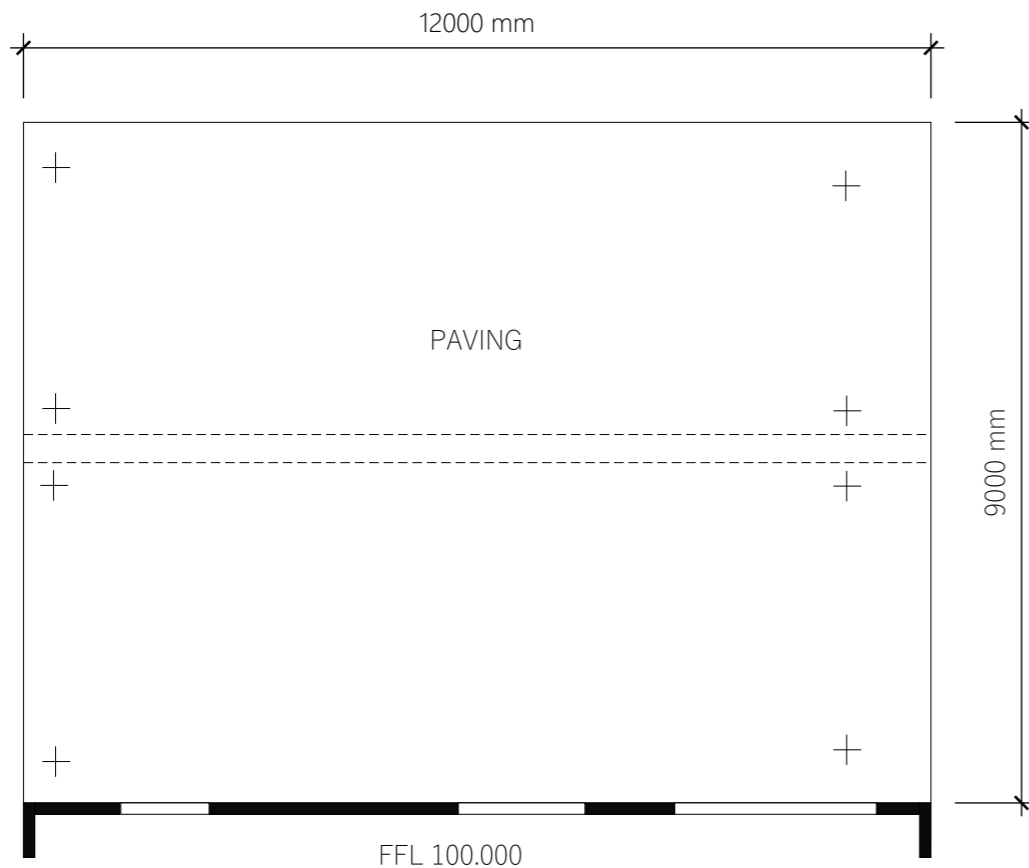
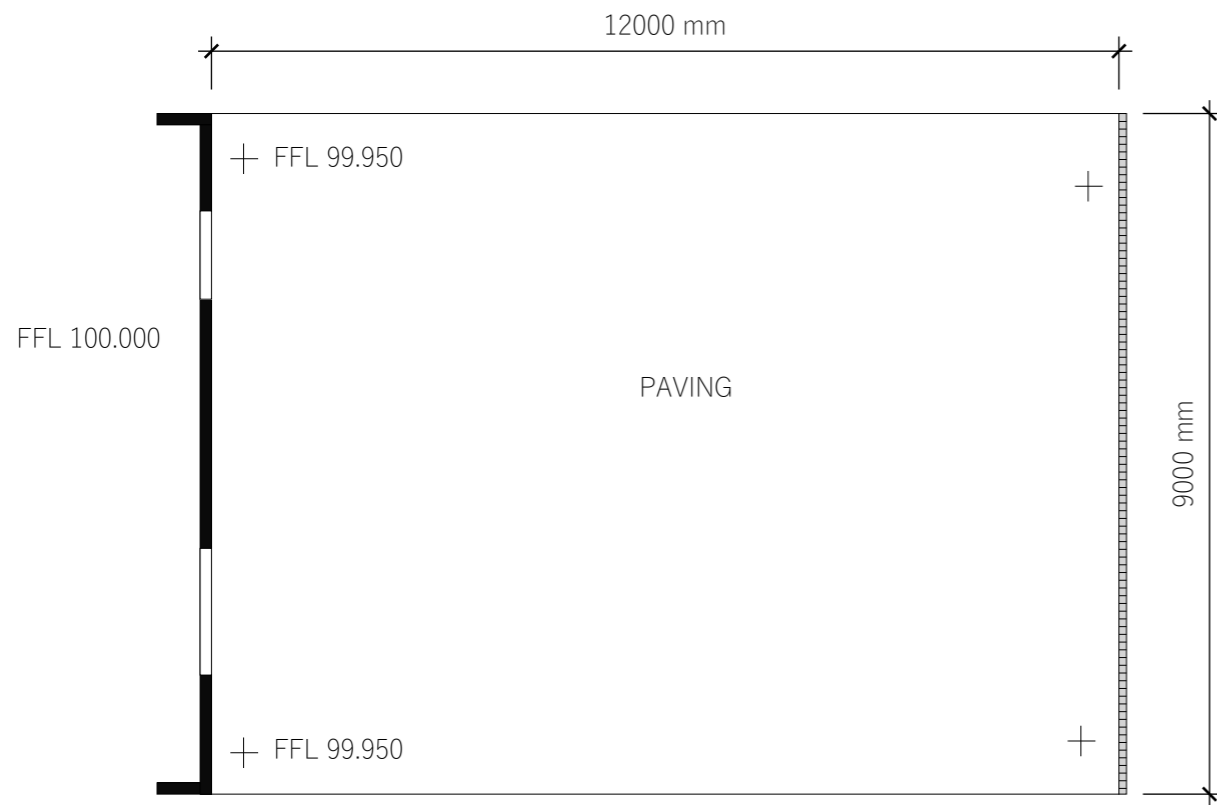

Refer to grading and drainage presentation more information

Standard Grading Percentages
 Lawn areas around 2-3% = 1:50 - 1:33
 Paving 1.5 - 2.5% = 1:75 - 1:40

Calculations

Height change in metres = Distance Covered in meters x Percentage grade
 (percentage divided by 100)

Percentage Grade = Height Change in metres / Distance Covered in meters x 100

For the following paved surface: Create a sheet grading falling from the left to the right into the strip drain. Use a standard paving grade and show:

- Direction with arrows
- Percentage of fall
- Spot levels where indicated

For the following paved surface: Create a valley grading towards the spoon drain in the centre. Use a standard paving grade and show:

- Direction with arrows
- Percentage of fall
- Spot levels and necessary points

Grading 2

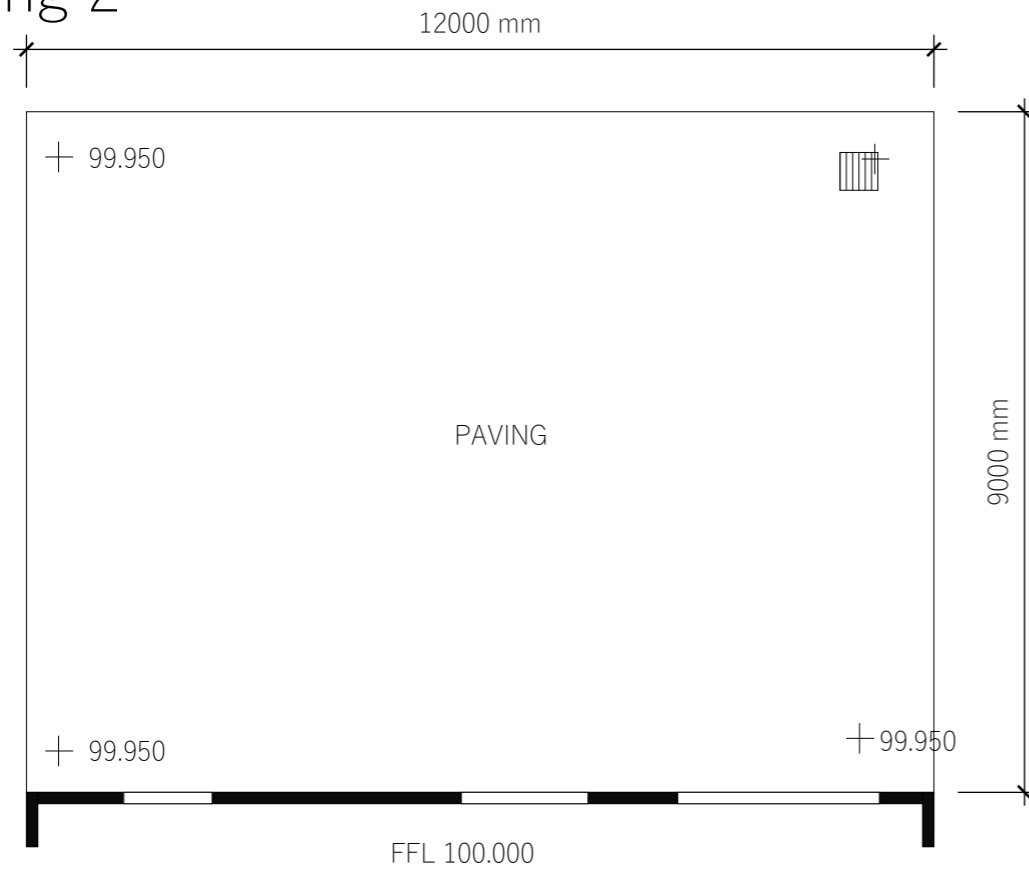

For the following Green Site paved proposed surface: Grade toward the drain in the top right. Use a standard paving grade and show:

- Direction with arrows
- Percentage of fall
- Spot levels where indicated

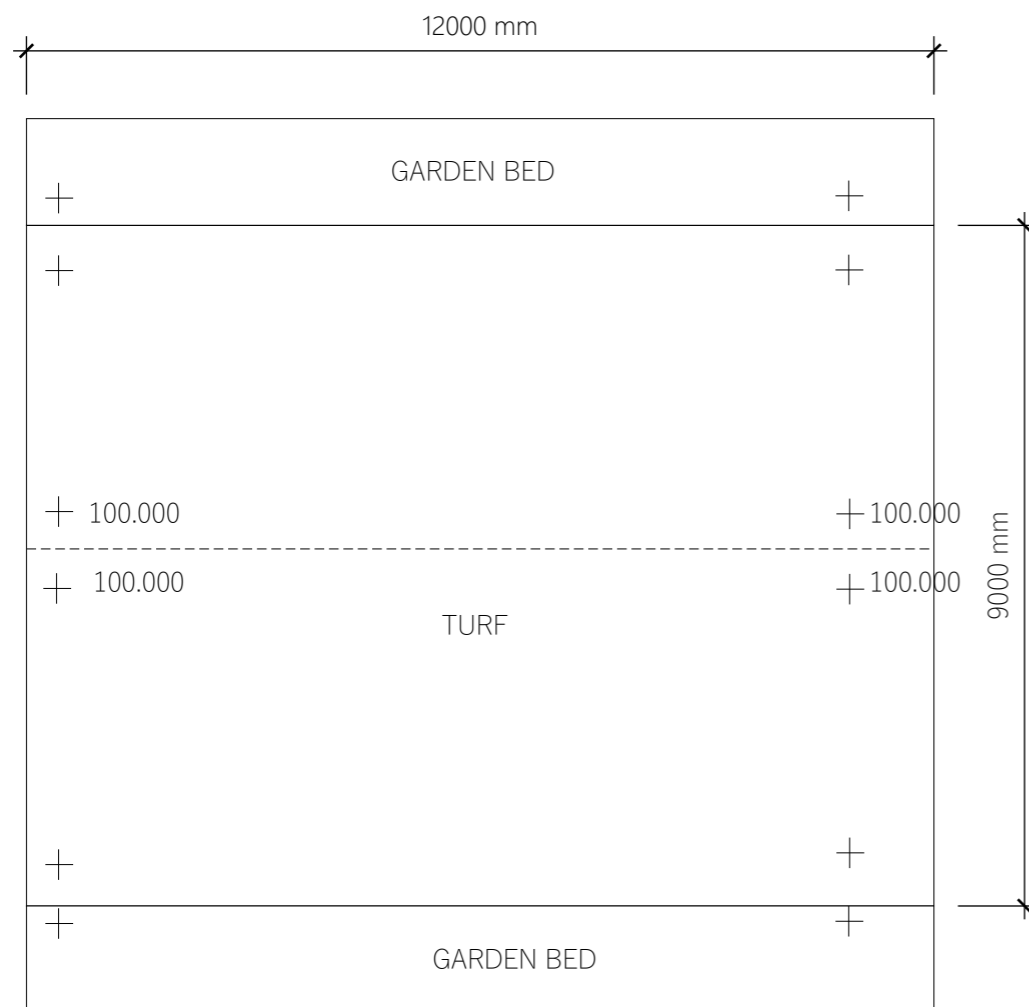

For the following turf surface: Create a grade away from the crown in the centre towards the top and the bottom garden beds. Garden beds should sit 50mm below the turf height. Use a standard turf grade and show:

- Direction with arrows
- Percentage of fall
- spot levels and necessary points

Grading 3

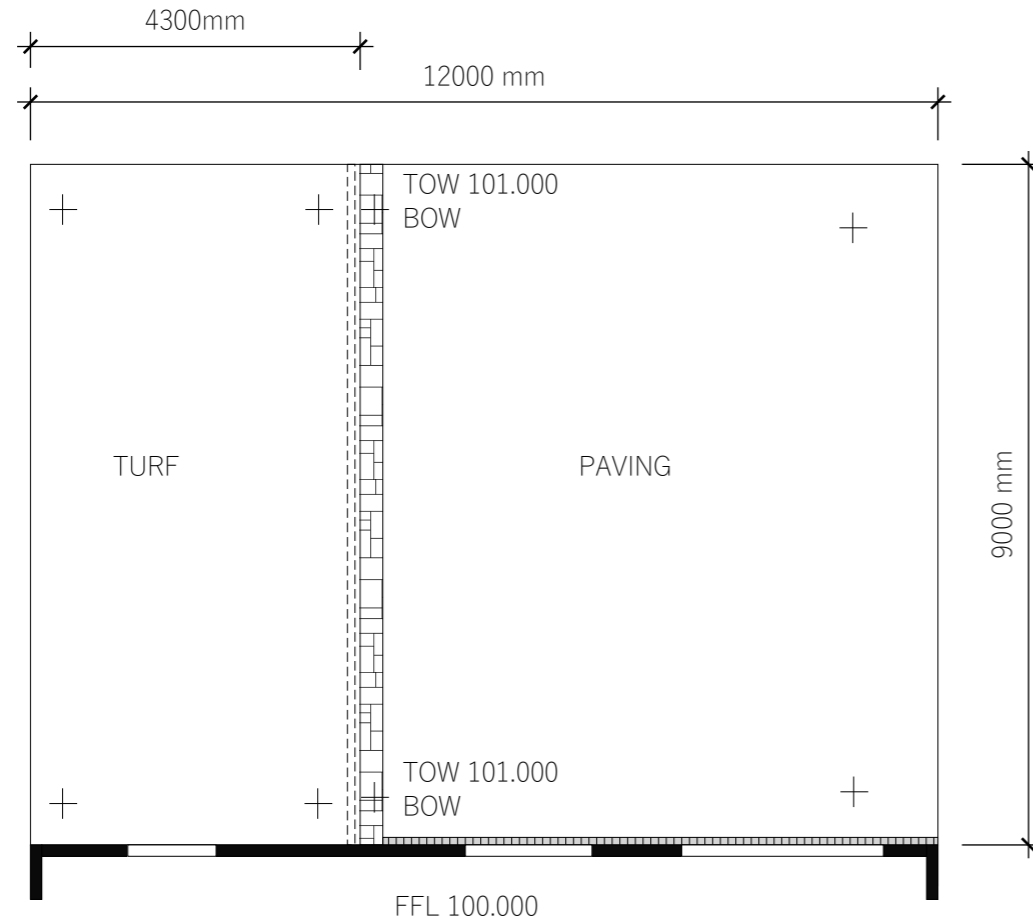

In this example there are two surfaces. On the left is turf. Grade this towards the retaining wall which has an Agi-drain behind it. Turf should fit 50mm below the top of the capping piece on the retaining wall. The lower level is paving. There must be a minimum of 50mm step down from the internal floor to the paving. Grade this down towards the strip drain. Show:

- Direction with arrows
- Percentage of fall
- Spot levels where indicated